

**ANDREW YULE & CO. LTD.
KARBALLA TEA ESTATE
(A Government of India Enterprise)
BANARHAT, JALPAIGURI, WEST BENGAL, 735202.**

NOTICE INVITING TENDERS

Karballa Tea Estate on behalf of ANDREW YULE & CO. LTD invites e-Tender under two part system (**Part I: Techno-Commercial Bid and Part II: Price Bid**) from bona fide and reputed **Company/Firm** for **Erection & Commissioning of H.T. Overhead line for Irrigation Pump House at Karballa Tea Estate**, the details of which are available in Annexure-IV "**Scope of Work / Technical Specification**" as specified in this tender document.

Tender document may be downloaded from MSTC website www.mstcecommerce.com/eprochome/aycl or www.andrewyule.com. Corrigenda or clarifications, if any, shall be hosted on the above mentioned websites only. AYCL reserves the right to accept or reject any tender.

Schedule of Tender

1.	TENDER NO.	KA/CAPEX/18-19/07 Dated. : 15.02.2019
2.	MODE OF TENDER	e-Procurement System Online submission of Part I - Techno-Commercial Bid and Part II - Price Bid through www.mstcecommerce.com/eprochome/aycl The intending bidders are required to submit their offer electronically through this e-tendering portal. No physical tender is acceptable by AYCL/MSTC
3.	E-Tender No. / Event No.	AYCL/TEA DIVISION/135/18-19/ET/388
4.	Date of publication of e-Tender through publication MSTC/AYCL websites and Central Public Procurement Portal	15/02/2019
5.	Date of availability of NIT to the Vendors for downloading	15/02/2019
6.	Earnest Money and other document	<input type="checkbox"/> "Earnest Money Deposit" of Rs.20000.00 (Rupees twenty thousand only) may be paid by D.D./Bankers Cheque favouring Andrew Yule &Co Ltd. A/c Karballa Tea Estate payable at banarhat/Siliguri. <input type="checkbox"/> Other document as described in Annexure – I, Sl. No. 2

7.	Last date of submission of EMD & other documents to the Manager, Karballa Tea Estate with an email confirmation to General Manager, Tea Division at chandan.bora@andrewyule.com	28/02/2019
8.	Date of Starting of e-Tender for submission of Online Techno-Commercial Bid and Price Bid at www.mstcecommerce.com/eprochome/aycl	To be intimated to the eligible vendor separately by email as well as through Corrigendum in the website.
9.	Date of closing of Online e-tender for submission of Techno-Commercial Bid & Price Bid at www.mstcecommerce.com/eprochome/aycl	To be intimated to the eligible vendor separately by email as well as through Corrigendum in the website.
10.	Date & time of opening of Part-I (Techno-Commercial Bid)	To be intimated to the eligible vendor separately by email as well as through Corrigendum in the website.
11.	Date & time of opening of Part-II (Price Bid)	To be intimated to the eligible vendor separately by email as well as through Corrigendum in the website.

List of Annexure

Important Instructions for E-procurement -	Annexure-I
Notice Inviting Tender	Annexure-II
General Information-	Annexure-III
Scope of Work / Technical Specification/ General Terms& Conditions	Annexure-IV

**ANDREW YULE & CO. LTD.
KARBALLA TEA ESTATE**

Important Instructions for E-procurement

Ref. E-Tender No.: AYCL/TEA DIVISION/135/18-19/ET/388

Ref. Tender No.: KA/CAPEX/18-19/07

This is an e-procurement event of Karballa Tea Estate, located at Banarhat, Jalpaiguri, of ANDREW YULE & COMPANY LTD Ltd.

You are requested to read the Terms & Conditions (Annexure- III, IV) of this tender before submitting your online tender. Tenderers who do not comply with the Conditions with documentary proof (wherever required) will not qualify in the Tender for opening of Price Bid.

1. Process of E-tender:

A) **Registration:** The process involves vendor's registration with MSTC e-procurement portal which is free of cost. Only after registration, the vendor(s) can submit his/their bids electronically. Electronic Bidding for submission of Techno-Commercial Bid as well as Price Bid over the internet will be done. The Vendor should possess Class III signing type Digital Signature Certificate. Vendors are to make their own arrangement for bidding from a PC connected with Internet. MSTC is not responsible for making such arrangement. (Bids will not be recorded without Digital Signature).

SPECIAL NOTE: THE PRICE BID AND THE COMMERCIAL BID HAS TO BE SUBMITTED ON-LINE AT www.mstcecommerce.com/eprochome/aycl

- 1) Vendors are required to register themselves online with www.mstcecommerce.com → e-Procurement → PSU / Govt. depts. → Register as Vendor under AYCL- Filling up details and creating own user id and password → Submit.
- 2) Vendors will receive a system generated mail confirming their registration in their email which has been provided during filling the registration form.

In case of any clarification, please contact MSTC/AYCL (before the scheduled time of the e-Tender).

Contact person for Techno Commercial clarification (ANDREW YULE & COMPANY LTD):

1. S.K. Jha
Manager,
Karballa Tea Estate, Banarhat, Jalpaiguri.
Contact No: 03563-252005
Email: yule.karballa@gmail.com

Contact person for Techno Commercial clarification (E-Commerce, MSTC Ltd):

- | | |
|---|---|
| <p>1. Mr. Pritam Biswas
Assistant Manager (ERO),
MobileNo: 9903248755,
Email: pbiswas@mstcindia.co.in</p> | <p>2) Mr. Mayank Jain,
Assistant Manager (ERO),
Mobile- 9721277969,
Email: mhjain@mstcindia.co.in</p> |
|---|---|
2. Mr. Vikash Kumar Jaiswal
Regional Manager (ERO),
Mobile- 9903042449,
Email: vikash@mstcindia.co.in
3. Landline: (033) 22901004

System Requirement:

- i) Windows XP-SP3 or above / Windows 7 Operating System
- ii) IE-7 or above Internet browser.
- iii) Signing & Encryption type digital signature
- iv) JRE 7 update 79 software to be downloaded and installed in the system. Security level should be medium
- v) To enable ALL active X controls and disable 'use pop up blocker' under Tools → Internet OpJns → custom level (Please run IE settings from the page www.mstcecommerce.com once)

2. Part-I: Submission of EMD & other Documents:

Within specified Date & time the vendor must submit the following documents to Manager , Karballa Tea Estate, P.O. : Banarhat, Dist : Jalpaiguri, West Bengal, 735202, Off-line.

- Earnest Money of Rs.20000.00 (Rupees twenty thousand only) by Demand Draft/ Bankers Cheque favouring Andrew Yule & Co. Ltd. A/C Karballa Tea Estate, Payable at Banarhat/Siliguri.
- General information, under Annexure-III complete in all respect along with desired information and document.
- Acceptance of Scope of Work/Technical Specification & Drawings, under Annexure-IV along with relevant information and documents without Price Sheet.
- Technical specification sheet & Drawings, with all desired details, duly signed and stamped as token of acceptance.

In case of failure to submit the EMD and other document within the stipulated time, the Tender may be rejected.

Part-II: Online Bid submission: On the basis of submission of EMD and other Documents at Karballa Tea Estate, P.O.: Banarhat, Dist: Jalpaiguri, West Bengal, 735202, the list of vendors who will participate in online Techno commercial and price bid submission will be finalized. Only those qualified bidders will be eligible to submit Online Techno-commercial and price bid.

Bidding in e-Tender:

- a. No interest will be paid on EMD. EMD of the unsuccessful bidder(s) will be refunded by Karballa Tea Estate. EMD to be paid along with the Document with in the last date as mentioned in SOT.
- b. The process involves Electronic Bidding for submission of Techno Commercial Bid as well as Price Bid.
- c. The bidder(s) who have submitted the EMD and documents to Karballa Tea Estate will be short listed by Manager, Karballa Tea Estate and those qualified bidders can only submit their Techno Commercial Bids and Price Bid through internet in MSTC website www.mstcecommerce.com → e-procurement → Psu / Govt depts. → Login under AYCL → My Menu → Auction Floor Manager → live event → Selection of the live event.
- d. The bidder should allow to run an application namely enApple by accepting the risk and clicking on run. This exercise has to be done twice immediately after opening of Bid floor. Then they have to fill up Common terms /Commercial specification and save the same. After that clicking on the Techno-Commercial bid, if this application is not run then the bidder will not be able to save / submit his Techno-Commercial bid.
- e. After filling the Techno-Commercial Bid, bidder should click 'save' for recording their Techno-Commercial bid. Once the same is done, the Price Bid link becomes active and the same has to be filled up and then bidder should click on "**Save**" to record their Price Bid. Then once both the Techno-Commercial bid & Price Bid has been saved, the bidder can click on the "**Submit**" button to register their bid.
- f. Vendors are instructed to use link in **My Menu** to **Upload Documents** in document library. Multiple documents can be uploaded. Maximum size of single document for upload is 5 MB.
- g. Once documents are uploaded in the library, vendors can attach documents through **Attach Document** link against the particular tender. For further assistance please follow instructions of vendor guide.
- h. In all cases, bidder should use their own ID and Password along with Digital Signature at the time of submission of their bid.
- g. During the entire e-tender process, the bidders will remain completely anonymous to one another and also to everybody else.

- h. The e-tender floor shall remain open from the pre-announced date & time and for as much duration as mentioned above.
- i. Techno-Commercial bid will be opened electronically on specified date and time as given in the NIT. Bidder(s) can download Technical Comparative statement.
- j. Price bid will be opened electronically on specified date and time given in the NIT. Bidder(s) can download Price Comparative statement.
- k. All entries in the tender should be entered in online Technical & Commercial Formats without any ambiguity.
- l. All electronic bids submitted during the e-tender process shall be legally binding on the bidder. Any bid will be considered as the valid bid offered by that bidder and acceptance of the same by the Buyer will form a binding contract between Buyer and the Bidder for execution of supply. Such successful tenderer shall be called hereafter **SUPPLIER**.
- m. It is mandatory that all the bids are submitted with Digital Signature Certificate otherwise the same will not be accepted by the system.
- n. Buyer reserves the right to cancel or reject or accept or withdraw or extend the tender in full or part as the case may be without assigning any reason thereof.
- o. No deviation of the terms and conditions of the tender document is acceptable. Submission of bid in the e-tender floor by any bidder confirms his acceptance of terms & conditions for the tender.
- p. Unit of Measure (UOM) is indicated in the e-tender Floor. Rate to be quoted should be in Indian Rupee as per UOM indicated in the e-tender floor/tender document.

E-tender cannot be accessed after the due date and time mentioned in NIT.

All notices / corrigendum and correspondence to the bidder(s) shall be sent by email only during the process till finalization of tender by KARBALLA TEA ESTATE/ANDREW YULE & COMPANY LTD/MSTC LTD. Hence the bidders are required to ensure that their corporate email I.D. provided is valid and updated at the stage of registration of vendor with MSTC. Bidders are also requested to ensure validity of their DSC (Digital Signature Certificate).

Any order resulting from this open e-tender shall be governed by the terms and conditions mentioned therein.

No deviation to the technical and commercial terms & conditions are allowed.

ANDREW YULE & COMPANY LTD / Karballa Tea Estate has the right to cancel this e-Tender without assigning any reason thereof.

The online tender should be submitted strictly as per the terms and conditions and procedures laid down in the website www.mstcecommerce.com/eprochome/aycl of MSTC Ltd.

The bidders must upload all the documents required as per terms of NIT. Any other document uploaded which is not required as per the terms of the NIT shall not be considered.

The bid will be evaluated based on the filled-in technical & commercial formats.

Bidders are requested to read the vendor guide and see the video in the page www.mstcecommerce.com/eprochome/mstc of MSTC Ltd. to familiarize them with the system before bidding.

Notice Inviting Tender:
Ref. E-Tender No.: AYCL/TEA DIVISION/135/18-19/ET/388
Ref. Tender No.: KA/CAPEX/18-19/07

Karballa Tea Estate on behalf of Andrew Yule & Co. Ltd., Tea Division, invites e-tender for Erection & Commissioning of H.T. Overhead line for Irrigation Pump House at Karballa Tea Estate located in the State of West Bengal.

Offers are invited from reputed Contractors for such items at specified locations.

Contractors interested to participate in the above Tender will have to :

- b) Get themselves registered (free of cost) as supplier with www.mstcecommerce.com/eprochome/aycl, our service provider.
- c) Submit the following document to Karballa Tea Estate, Banarhat, Jalpaiguri, West Bengal within 15 days from the date of publication of advertisement, off line -
 - General Information Sheet complete in all respect duly signed and stamped.
 - Earnest money of Rs.20000/- by Demand Draft/ Bankers Cheque favouring Andrew Yule & Co. Ltd. A/C Karballa Tea Estate payable at Banarhat/Siliguri.
 - Commercial Terms & Conditions Sheet, duly signed and stamped as token of acceptance.
 - Technical specification sheet & Drawings, with all desired details, duly signed and stamped as token of acceptance.

The following pre-qualification criteria would apply, which may be relaxed at the sole discretion of Andrew Yule & Co. Ltd. / Karballa Tea Estate.

- The Bidder should be a Contractor having minimum 3 years of Construction / Erection & Electrification experience & holding authority to deal with Andrew Yule & Co. Ltd. / Karballa Tea Estate on behalf of the Contractor, for the job quoted for. This should be supported by appropriate documentary evidence. **Vendors who have the experience of work at Tea Gardens will be given preference.**
- The Bidder shall be a registered Company/Firm and possess valid GST, PAN registration certificates.
- The Contractor should have own local support office / franchisee presence for the locations namely Banarhat / Siliguri and should be able to provide a Service Engineer as and when required.

General Information**Ref. E-Tender No.: AYCL/TEA DIVISION/135/18-19/ET/388****Ref. Tender No.: KA/CAPEX/18-19/07**

The applicants are required to furnish full information to the queries included in this form. In giving the particulars, the supporting documents/certificates as called for per queries at places, must be tagged with the application for evidencing the information furnished in the application.

1. Particulars of Company

- 1.1 Name of the Company :
 1.2 Nature of business : Dealer / Distributor / Contractor
 1.3 Full address :
 1.4 Phone No. :
 1.5 Fax No. :
 1.6 E-mail ID :

2. Details of Certificate

SI No.	Particulars	Registration No.	Remarks
1.	Income Tax		Copy of Registration Certificate / PAN Card to be attached
2.	GST		Copy of Registration Certificate to be attached
5.	Trade Licence		Copy to be attached

3. List of Service Centers

Sl. No	Location	Type of Centre		Bidders to Provide full address & Telephone No
		Company Operated	Franchised	
1	Banarhat/Dhupguri/Malbazar			
2	Siliguri			

4. Details of Banker

1.	Name of the Bank	
2.	Name of the Branch	
3.	Branch Code	
4.	Address	
5.	IFSC No.	
6.	Account No.	

5. List of supplies of identical :
items made in last 3 years.
with customer reference

6. Copies of Purchase Orders :
received from major Customer
for identical type of items
(minimum 2 order copies)

I/we hereby certify that the particulars furnished by me/us above are true to the best of my / our knowledge and belief and mis-representations of facts will render me/us liable to my/our action as may be deemed fit by Andrew Yule & Co. Ltd. (Tea Division) / Karballa Tea Estate & have the sole discretion to reject or accept my/our candidature.

Signature of the Applicant)
Office Stamp/Seal.

Place :

Date ;

List of Enclosures :

General Terms & Conditions**Ref. E-Tender No.: AYCL/TEA DIVISION/135/18-19/ET/388****Ref. Tender No.: KA/CAPEX/18-19/07**

1. Scope of Work:
 - Erection & Commissioning of H.T. Overhead line for Irrigation Pump House complete in all respect to the respective location.
2. Location of Site:
 - Karballa Tea Estate, P.O. Banarhat, Dist. Jalpaiguri, West Bengal.
3. Requirement:

As detailed in specification.
4. Liquidated Damage:

In the event of failure on the part of the contractor to complete entire work against the order to our full satisfaction within the specified period of completion, we may recover from the contractor as liquidated damages, a sum equivalent to ½% of contract value for each week or any part thereof default, where the delivery thereof will be accepted after expiry of the date stipulated for this purpose, but limited to a maximum of 10% of contract value.
5. Force Majeure:

Any delay or failure in the performance of either party hereto will not constitute default thereunder or give rise to any claim for damages, if any, to the extent such delays or failure of performance is caused by the occurrence such as acts of god or the public enemy, appropriation or confiscation of facilities by Govt. Authorities, acts of war, rebellion or sabotage, fires, explosions, riots and illegal strike.
6. Risk Purchase:

In case the contractor fails to execute the contract fully or partly, the purchaser shall have the right to execute the work through other agencies, as decided by the purchaser at the contractor's cost and risk after giving two weeks notice in writing.
7. Terms of payment:
 - Part payment will be released according to the progress of work with 10% retention at each stage described in the scope of work which will be returned after 1 year of completion of the project if no dispute arises regarding quality of the project.
 - Statutory deductions will be made as per rules.
9. Price Variation:

The quoted price should remain firm during pendency of the contract.
10. Replacement of the defective/substandard material/job has to be made good within 15 days.
11. Management reserves the right of pre-delivery inspection.
12. Work has to be completed within 60 days from the Order.
13. Management reserves the right to split the order wherever found necessary with majority job to be reserved for L1.

14. The tenderers are requested to ensure Earnest Money Deposit along with the Tender in the following manner, which will be converted into Security Deposit for the successful bidder/s and will be released on completion of job.

EMD Amount ---- Rs.20000/-

EMD to be submitted by D.D./ Bankers Cheque favouring Andrew Yule & Co. Ltd. A/C Karballa Tea Estate payable at Banarhat/Siliguri.

12. Decision for awarding contract/job is vested with the Management so as to reject.
13. Incomplete "Quotation/Offer" is liable to be rejected.
14. The offer must be valid for a minimum of 180 days from the date of E-Bidding.
15. All the applicable labour laws relating to deployment of labourers/employees will be strictly followed in executing the contract.
16. All disputes are subject to Jalpaiguri Jurisdiction only.

Signature of the Applicant)
Office Stamp/Seal.

Place :

Date ;

Technical specification and requirement**Ref. E-Tender No.: AYCL/TEA DIVISION/135/18-19/ET/388****Ref. Tender No.: KA/CAPEX/18-19/07****Scope of work – Erection & Commissioning of H.T. Overhead line for Irrigation Pump House at Karballa Tea Estate.****Description of work :****Part A : Tapping from Existing Line at Factory side to Sec. No. 17**

Ser No	DESCRIPTION
1.	Supply of 26 ft long PCC Pole. - 59 Pcs.
2.	Carrying 26 ft. long PCC Pole. - 59 Pcs.
3.	Supply of M.S. Channel, Angle, Flat, Paint, Electrode (for `V' Bracket, Top Adopter, D.B., T.P., M.S. structure, M.S. frame, Clamp, Saddle, extension. - 2.8 Ton
4.	Supply of 6 ft long Stay Set, Anchore Plate, Bow, complete set. - 47 Sets. `M'
5.	Supply of 6" long H.T. Guy Insulator. - 50 Pcs
6.	Supply of 7/10 G.I. Stay wire. - 180 Kgs
7.	Supply of H.T. 11 KV Brown Glassed Pin Insulator with G.I. Stud, Nut, washer. - 159 Pcs
8.	Supply of H.T. 11 KV Grade Brown Glassed `Disc' Insulator with straining clamp, bolt, nut, (Hardware fittings). - 56 Pcs
9.	Supply of 5 ft. long G.I. Earth spike, Bolt, Nut. - 59 Pcs
10.	Supply of 0.030 (Weasel) ACSR conductor wire. - 5954 Mtrs.
11.	Supply of 0.03 ACSR binding wire. - 40 Kgs
12.	Supply of H.T. 11 KV TP, GOAB switch with operating Handle, Sq. Rod. - 2 Sets
13.	Supply of Barbed wire, Anti-climbing device for PCC pole. - 59 Nos
14.	Supply of SWG 6 G.I. wire for Earth spike. - 700 Mtrs
15.	Supply of SWG 8 G.I. wire. - 5260 Mtrs
16.	Supply of P.G. Clamp. - 72 Nos.
17.	Supply of 11000 Volts 8" x 6" Caution Plate. - 46 Nos.
18.	Supply of 8" Long `I' Bolt, Nut, washer.

	- 30 Nos.
19.	Supply of various sizes M.S. Bolt, Nut, washer (½” x 2”, ½” x 3”, ½” x 4”, ½” x 6”, 5/8” x 8”). - Lot.
20.	Supply of Cement, Sand, Pebble. - Lot
21.	Supply of 2 ½” Cable Protection pipe. - 20 ft.
22.	Supply of H.T. 11 KV grade Lightning Arrestor with Clamp (3 Nos. in one set). - 2 Sets.
23.	Supply of 3 Core x 120 Sq.mm H.T. 11 KV grade XLPE cable (H.T. & L.T. Crossing). - 50 Mtrs.
24.	3 Core x 120 Sq.mm H.T. 11 KV grade Heat-shrink joint, out-door joint. - 2 Sets

Part B : Supply of Materials for Electrification work of Step-down Sub-station for Irrigation Pump, Sec. No. 17 (Motor 45 x 1 Submirsal & 50 x 2 Nos. Booster)

Ser No	DESCRIPTION
1.	Supply of Cubicle type, Floor mounting L.T. Distribution Panel Board, made of 14/16 SWG CRC sheet with Powder coated paint, fitted with 400 Amps. Capacity Alu. Busbar Panel Board comprising with 1 Set Incoming Feeder 400 Amps. TPN MCCB with Thermal Magnetic release, Rotary Operating Handle, Digital Ammeter, Volt Meter, Selector Switch, C.T. Phase indicating lamp with Control MCB, 3 Sets Out-going Feeders 125 Amps. TPN Switch Fuse with HRC fuse, ON Indicating lamp, Digital Kwh Meter with C.T. and control MCB, 1 No. Out-going Feeder 32 Amps. TPN MCB. - 1 No.
2.	Supply of H.T. 11 KV Grade Oil Switch Fuse Unit, Type-`VLE' with both sides in & out-going cable Box, make – Voltamps. - 1 No
3.	Supply of H.T. 11 KV Grade 25 Amps. HRC Fuse, make E.E. - 3 Nos. `M'
4.	3 Core x 120 Sq.mm H.T 11 KV grade XLPE cable. - 50 Mtrs.
5.	3 Core x 120 Sq.mm H.T 11 KV Grade cable Heat-shrink joints with Lugs, Tapes, complete set.
	a) Out-door type. - 1 Set
	b) In-door type. - 3 Sets

6.	L.T. 1.1 KV Grade XLPE cable for Panel Board motor connection :-
a)	3.5 Core x 240 Sq.mm cable. - 15 Mtrs.
b)	3.5 Core x 70 Sq.mm cable. - 12 Mtrs.
c)	3 Core x 70 Sq.mm cable. - 20 Mtrs.
d)	3 Core x 35 Sq.mm cable. - 70 Mtrs.
7.	Following 1.1 KV Grade L.T. XLPE cable jointing materials :-
a)	3.5 Core x 240 Sq.mm cable. - 2 Joints.
b)	3 & 3.5 Core x 70 Sq.mm cable. - 6 Joints.
c)	3 Core x 35 Sq.mm cable. - 8 Joints
8.	Earthing Station materials 50 mm x 3 Mtr. long G.I. Electrode, Charcoal, Salt as per I.E. Rules. - 6 Nos
9.	Supply of 40 mm x 6 mm G.I. flat, galvanized. - 180 Kgs
10.	57 mm PVC Rubberized sleeves. - 50 ft.
11.	50 mm Earth funnel with Reducer. - 6 Nos.
12.	Providing various sizes G.I. Bolt, Nut, Washer for Earthing Job. - Lot
13.	3" x 10 ft long PVC Pipe. - 10 ft.
14.	Earth Bus Test Link for Transformer Neutral. - 1 No.
15.	Supply of copper wire for Doors and Windows Earthing. - Lot
16.	Supply of 15 KVAr Capacitor, Delta connected, heavy duty enclosure, 63 Amps. T.P. MCB, L & T, Enclosure M.S. Box, fixing channel, 3 Nos. 6 Sq.mm copper flexible wire in PVC flexible pipe, coupling joint 4 Nos. Each copper earthing wire etc. for Induction Motor. - 3 Sets

Part C : Erection of H.T. 11 KV Overhead Irrigation Line tapping from Factory side existing Overhead Line to Sec. No. 17 (approx 2 K.M.)

Ser No	DESCRIPTION
1.	Route survey of H.T. Irrigation Line from Factory to Sec. No. 17 at Karballa T.E. - Approx 2 KM.

2.	Digging, erection of 26 ft. long PCC Pole, grouting. - 59 Nos.
3.	Fabrication M.S. materials, `V` Bracket, top adopter, D.P. & T.P. Pole structure, bracket for GOAB, L.A., making clamp, saddle, welding, drilling of holes, painting, fixing on pole. - 2.8 Ton.
4.	Digging, erection of Stay set, plate, Bow, re-filling, masonry Dhalai. - 47 Sets
5.	Laying of stay wire, Guy Insulator both side binding, also bow & clamp binding. - 47 Sets
6.	Erection of 11 KV Brown glassed Pin Insulator with Stud, bolt, on PCC pole Bracket. - 159 Sets
7.	Erection of Brown glassed `Disc` insulator with straining clamp & accessories on pole structure. - 56 Sets
8.	Erection of Earth spike with SWG 6 G.I. wire, binding around the pole from ground earth spike to pole top M.S. structure, grouting. - 59 Pcs.
9.	Erection of 4 Ply Barbed wire binding, 75 cm around the pole as anti-climbed device. - 59 Nos.
10.	Drawing 0.030 (Weasel) conductor wire, straining & sagging, `Disc` & `Pin` Insulator binding, Jumpering connection. - 5954 Mtrs.
11.	Erection of GOAB Isolator switch, Sq. Rod, operating handle on D.P. Pole structure, alignment, connection conductor wire fuse system operation. - 2 Sets
12.	Drawing cradle guard with 2 x 8 SWG G.I. wire for continuous & from cross branching as an interval of 2.5 Mtrs, `I` Bolts fixing, sagging, binding. - 32 Span
13.	Erection of 11000 Volts Caution Board on pole, binding. - 46 Pcs
14.	Erection of P.G. Clamp, size 0.030 for Jumpering connection on D.P., T.P., binding. - 72 Nos.
15.	Erection of H.T. 11 KV Lightning Arrestor (3 Nos. in one set) on pole structure, wire, lugs connection, binding, between Line & ground. - 2 Sets.
16.	Laying of 3 Core x 120 Sq.mm cable for Road WBSEDCL H.T. Line & L/Line L.T. Line crossing. - 50 Mtrs.
17.	3 Core x 120 Sq.mm H.T. 11 KV grade XLPE cable out-door type heat-shrink joint, lifting on pole, connection. - 2 Joints

Part D : Erection of Step-down Substation Electrification work for H.T.
Irrigation Sec. No. 17 (Motor Booster 50 H.P. x 2 Nos. & Submirsal
Motor 45 H.P. x 1 No.

Ser No	DESCRIPTION
1	Being blue print drawing of H.T 11 KV Step-down Sub-station equipments, H.T. 11 KV overhead line from Factory Tapping position to Irrigation place with S.P., D.P., T.P. pole position, single Line diagram, earthing system and submission to the Garden authority. - 1 Job
2.	Fabrication channel, drilling of holes, painting, grouting on ready trench, installation of 400 Amps. T.P.N. MCCB Panel Board, cubicle type, floor mounting, checking meter instruments, testing & commissioning. - 1 Job.
3.	Fabrication channel, painting, grouting on ready trench, installation of 250 KVA Indoor type Step-down (Dyn-11) Transformer, fixing stopper & accessories, testing & commissioning (Pump side). - 1 Job.
4.	Fabrication channel, painting, grouting on ready trench, installation of 11 KV 200 Amps., 250 MVA, Oil Switch Fuse unit, fixing fuses, Transformer oil, testing & commissioning. - 1 Job.
5.	Laying of 3 Core x 120 Sq.mm H.T. 11 KV XLPE cable in trench. - 50 Mtrs
6.	3 Core x 120 Sq.mm H.T 11 KV Grade cable Heat-shrink joint, Crimping Lugs, Jointing, Connection, Tapping.
	a) Out-door type joint. - 1 No.
	b) In-door type joint. - 3 Nos.
7.	Being High Voltage testing of Sub-station H.T. equipments, cable, Earthing station by the contractor & Sub-mission of test report. - 1 Job
8.	Laying of the following 1.1 KV grade XLPE cable in trench :-
	a) 3.5 Core x 240 Sq.mm cable. - 15 Mtrs
	b) 3 & 3.5 Core x 70 Sq.mm cable. - 32 Mtrs
	c) 3 Core x 35 Sq.mm cable. - 70 Mtrs
9.	Following cable gland binding, crimping socketing, end termination connection :-
	a) 3.5 Core x 240 Sq.mm cable. - 2 Joints.
	b) 3 & 3.5 Core x 70 Sq.mm cable. - 6 Joints.
	c) 3 Core x 35 Sq.mm cable. - 8 Joints.
10.	Making Earthing station from ground level to top as per I.E. Rules, making clamp, welding, fixing bolt & nut.

	- 6 Nos
11.	Laying of 40 mm x 6 mm G.I. flat for equipments earth, Neutral & L.A. - 180 Kgs.
12.	Planning, supervision, after installation, testing & commissioning of sub-station equipments, H.T. Overhead Line, commission of the system. - 1 Job
13.	Laying of 50 mm PVC Sleeves for covering bare flat for Neutral & L.A. - 50 ft. `E`
14.	Making Earth Bus Test Link, grouting. - 1 No.
15.	Making Sub-station room Doors and Windows earthing, connection, fixing bolt & nut. - 1 No.
16.	Fabrication M.S. frame, structure, welding, drilling of holes, painting, grouting on trench, erection of Star/Delta Starter, Drum controller, Submirsal Pump Panel. - 4 Sets.
17.	Laying of cable protection pipe. - 30 ft @ Rs. 20.00 Per ft.
18.	Laying of G.I. wire for M.S. frame, switch, Starter, motor earthing. - 1 Job
19.	Fabrication M.S. frame grouting, erection of 15 KVAR L & T Capacitor, Enclosure type, 63 Amps T.P. MCB in M.S. Box, fixing channel, laying of 3 Nos. 6 Sq.mm copper flexible wire in PVC flexible pipe, crimping copper socket, 4 Nos. coupling joint, earthing. - 3 Sets

Note :

1. All the materials should be of ISI marked.
2. Pole should be supplied along with Test Certificate.

Signature of the Applicant)
Office Stamp / Seal.

Place :
Date :

Technical specification and requirement
Ref. E-Tender No.: AYCL/TEA DIVISION/135/18-19/ET/388
Ref. Tender No.: KA/CAPEX/18-19/07

DRAWING / 01

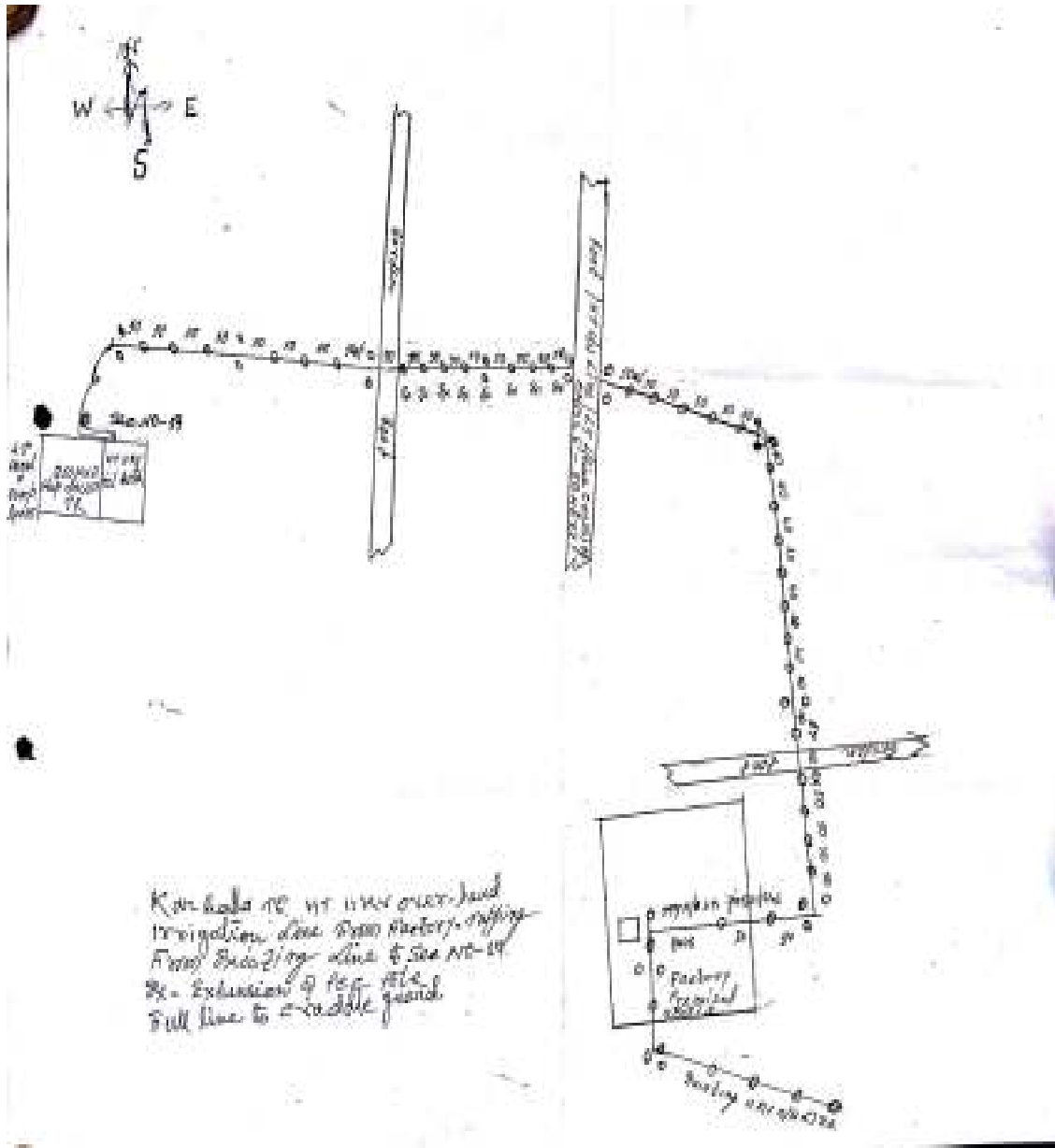

Place :
Date :

(Signature of the Applicant)
Office Stamp / Seal.

Technical specification and requirement
Ref. E-Tender No.: AYCL/TEA DIVISION/135/18-19/ET/388
Ref. Tender No.: KA/CAPEX/18-19/07

DRAWING / 02

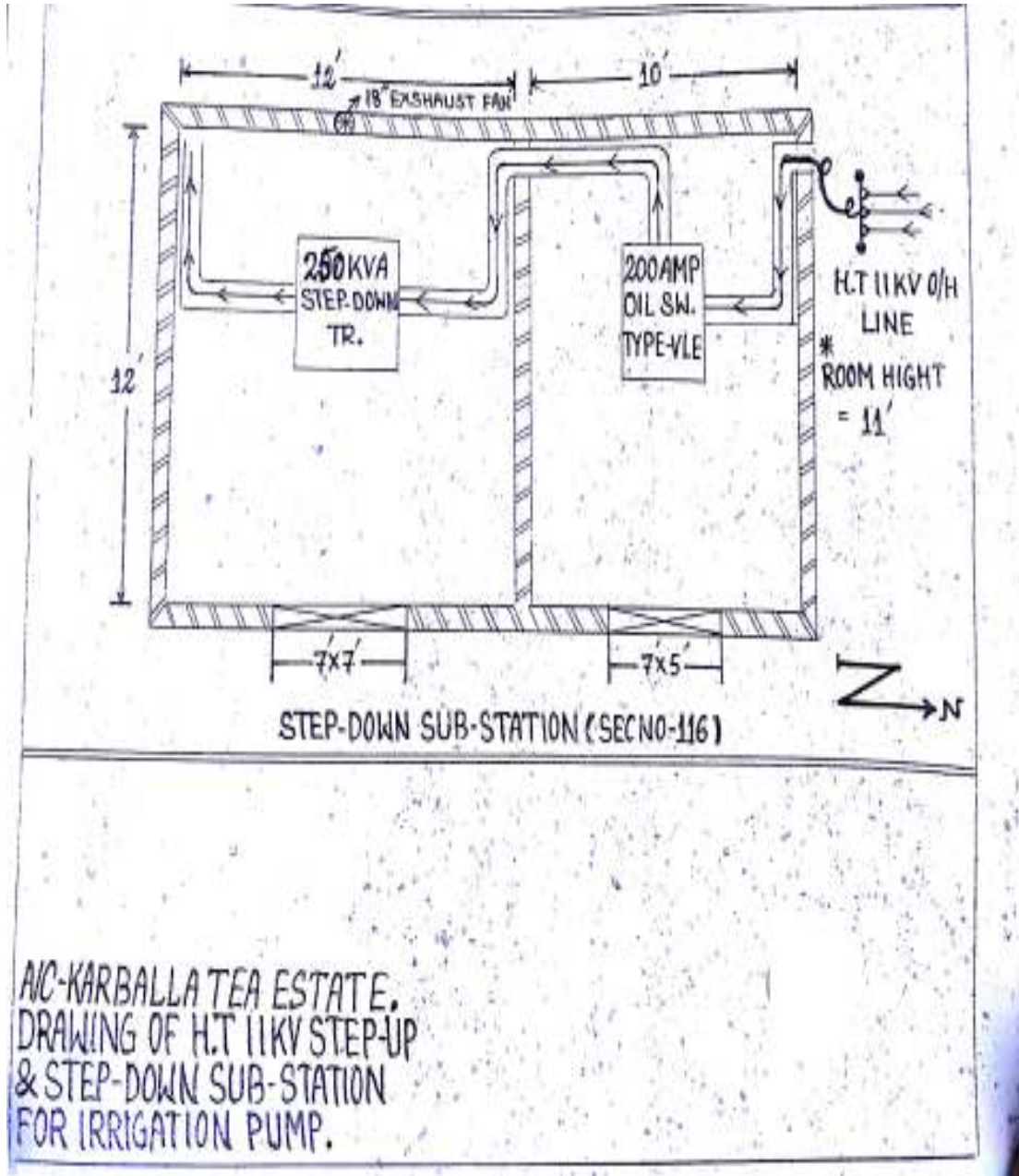

Place :
Date :

(Signature of the Applicant)
Office Stamp / Seal.

Karbala Tea Estate**Ref. E-Tender No.: AYCL/TEA DIVISION/135/18-19/ET/388****Ref. Tender No.: KA/CAPEX/18-19/07****PRICE SHEET****(For Online submission)**

Sl. No.	Name of Items	Unit site cost (in Rs.)	Packing, Forwarding & Transportation Charges (in Rs.)	Applicable Taxes (in Rs.)	Contract Value (in Rs.)
01.	Erection & Commissioning of H.T. Overhead line for Irrigation Pump House at Karbala Tea Estate as detailed in Annexure IV along with Drawing/01 & 02.				